



TECHNICAL **DIAGRAMS**



CIR-PARTS-LIST

01706 353 633

WWW.FOODSERVICESPARES.COM

C I R

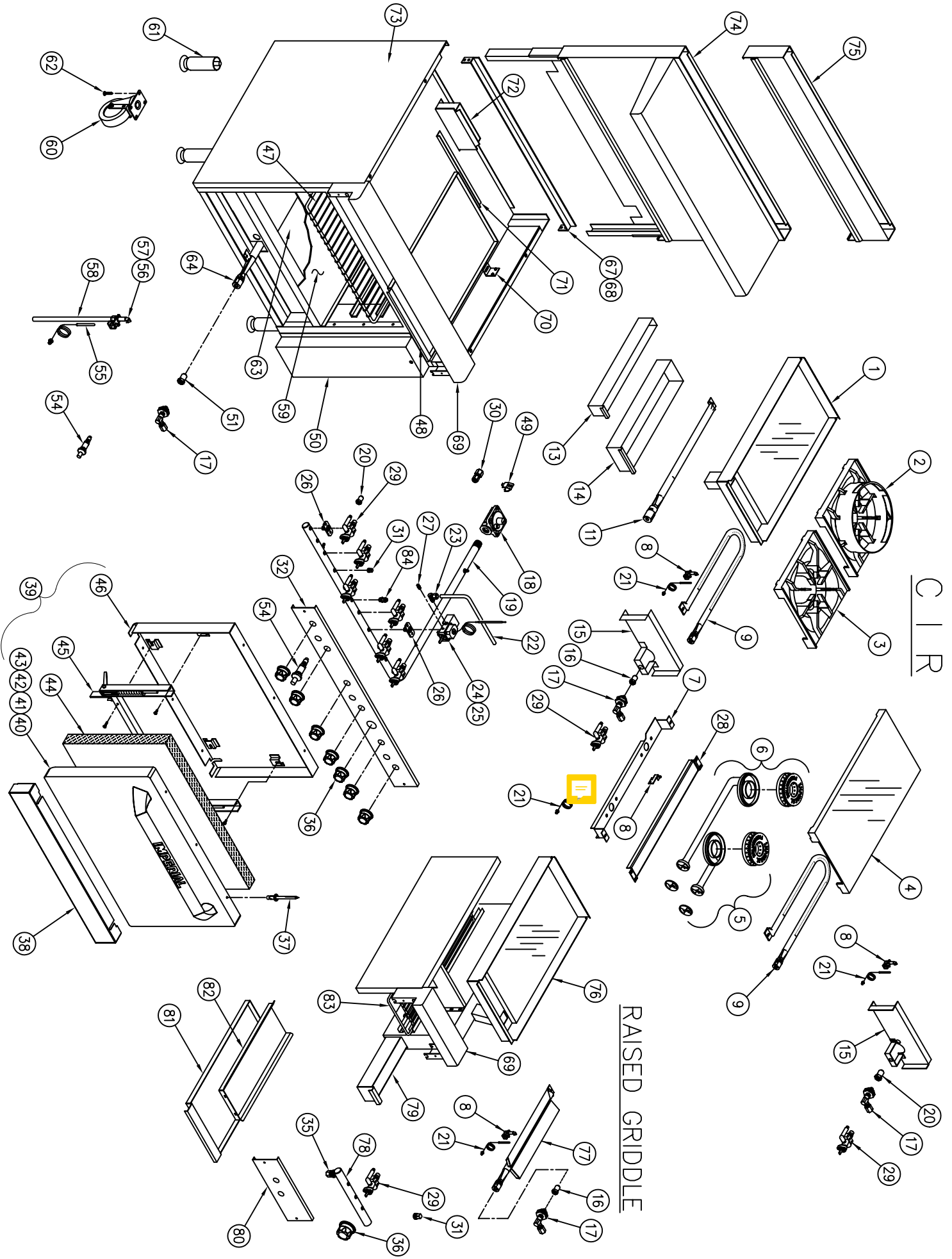

RAISED GRIDDLE

CIR Series - Medium Duty Ranges w/ Standard Oven

ITEM NO	DESCRIPTION	PART #	24"	36"	48"	60"	72"
1	12" GRIDDLE PLATE ASSEMBLY	20006	1	1	1	1	1
	24" GRIDDLE PLATE ASSEMBLY	20007	1	1	1	1	1
	36" GRIDDLE PLATE ASSEMBLY	20008		1	1	1	1
	48" GRIDDLE PLATE ASSEMBLY	20009			1	1	1
	60" GRIDDLE PLATE ASSEMBLY	20010				1	1
	72" GRIDDLE PLATE ASSEMBLY	20011					1
2	WOK RING	21065	Optional	Optional	Optional	Optional	Optional
3	12" X 12" TOP GRATE (CAST IRON)	1233	4	6	8	10	12
4	HOT TOP (POLISHED) 12" X 24"	1190	2	3	4	5	6
5	OPEN BURNER FRONT VENTURI	1231	2	3	4	5	6
	ANTI CLOGGING BURNER HEAD	2119	4	6	8	10	12
	WOK JET BURNER HEAD	1230-J	4	6	8	10	12
	SAUTE BURNER HEAD	1230-S	4	6	8	10	12
	OPEN BURNER AIR SHUTTER/MIXER ONLY	1007	4	6	8	10	12
6	OPEN BURNER REAR VENTURI	1232	2	3	4	5	6
	ANTI CLOGGING BURNER HEAD	2119	4	6	8	10	12
	WOK JET BURNER HEAD	1230-J	4	6	8	10	12
	SAUTE BURNER HEAD	1230-S	4	6	8	10	12
	OPEN BURNER AIR SHUTTER/MIXER ONLY	1007	4	6	8	10	12
7	BURNER SUPPORT BRACKET (USED WITH PN 10001)	20046	2	3	4	5	6
	PILOTLESS BURNER SUPPORT BRACKET	20048	2	3	4	5	6
8	PILOT BURNER (UMBRELLA SHAPED HEAD)	10001	2	3	4	5	6
9	GRIDDLE OR HOT TOP BURNER ("U" SHAPE) W/ AIR SHUTTER	1032	2	3	4	5	6
10	1/4" FITTING NUT (USED WITH PN 1651)	1633	4	6	8	10	12
11	GRIDDLE BURNER ("I" SHAPE) W/ AIR SHUTTER	1033	1	2	3	4	5
12	3/16" FITTING NUT (USED WITH PN 10001)	1634	2	3	4	5	6
13	2" WIDE GREASE CAN	20040	1	1	1	1	1
14	4" WIDE GREASE CAN	20041	1	1	1	1	1
15	12" GRIDDLE FRONT BAFFLE	20031	1	1	1	1	1
	24" GRIDDLE FRONT BAFFLE	20032	1	1	1	1	1
	36" GRIDDLE FRONT BAFFLE	20033		1	1	1	1
	48" GRIDDLE FRONT BAFFLE	20034			1	1	1
	60" GRIDDLE FRONT BAFFLE	20035				1	1
	72" GRIDDLE FRONT BAFFLE	20036					1
16	GRIDDLE OR RAISED GRIDDLE/BROILER ORIFICE, NATURAL GAS	2065	1	2			
	GRIDDLE OR RAISED GRIDDLE/BROILER ORIFICE, PROPANE GAS	2068-1	1	2			
17	ORIFICE 90° ELBOW (BRASS), WITHOUT ORIFICE	37188	1	1	2	2	2
18	GAS PRESSURE REGULATOR 3/4" (NATURAL GAS)	1050	1	1	1	1	1
	GAS PRESSURE REGULATOR 3/4" (PROPANE GAS)	1051	1	1	1	1	1
19	MANIFOLD PIPE (CALL FACTORY FOR MORE INFO)		1	1	1	1	1
20	OPEN BURNER ORIFICE, NATURAL GAS	2063	4	6	8	10	12
	OPEN BURNER ORIFICE, PROPANE GAS	2068	4	6	8	10	12
	HOT TOP ORIFICE, NATURAL GAS	2063	2	3	4	5	6
	HOT TOP ORIFICE, PROPANE GAS	2068	2	3	4	5	6
21	OPEN BURNER THERMOCOUPLE (USED WITH PN 10001)	1129	2	3	4	5	6
	OPEN BURNER THREADED THERMOCOUPLE	1149	2	3	4	5	6
22	3/8" ALUMINIZED TUBING (**SPECIFY LENGTH OF TUBING)	2102-**	in.	in.	in.	in.	in.
23	STRAIGHT FITTING (USED WITH PN 1179)	1626	2	2	2	4	4
24	OVEN THERMOSTAT FOR CIR	36014	1	1	1	2	2
	48" EXTENSION (USED WITH PN 36014)	36016	1	1	1	2	2
	18" THERMOCOUPLE (USED WITH PN 36014)	36017	1	1	1	2	2
25	GRIDDLE THERMOSTAT FOR CIR	36015	1	2	2	3	3
26	THERMOSTAT SADDLE MOUNT	1104	1	1 OR 2	1 OR 2	2 OR 3	2 OR 3
27	STRAIGHT FITTING FOR OVEN PILOT (USED WITH PN 1179)	1628	1	1	1	2	2
28	TOP GRATE SUPPORT BRACKET	21016		1	2	3	4
29	OPEN BURNER PILOTLESS VALVE	1660-L	4	6	8	10	12
	("L" FOR LEFT, "R" FOR RIGHT)	1660-R					
	OPEN BURNER, GRIDDLE, OR RAISED GRIDDLE VALVE (W/O ORIFICE)	1651-L	2	3	4	5	6
	("L" FOR LEFT, "R" FOR RIGHT)	1651-R					
30	ADAPTER (USED WITH PN 1651)	1627	2	3	4	5	6
31	1/8" PLUG	1013	1 OR 2	1 OR 2	1 OR 2	1 OR 2	1 OR 2
32	VALVE COVER - STAINLESS STEEL (CALL FACTORY FOR MORE INFO)		1	1	1	1	1
33	1/4" INVERTED COMPRESSION NUT (USED WITH PN 1159)	1280	1	2	2	3	3
34	ELECTRODE (USED WITH PN 10001)	1256	2	3	4	5	6
	ELECTRODE FOR PILOTLESS BURNERS	1257	2	3	4	5	6
35	STRAIGHT FITTING (BRASS)	1605	2	2	2	4	4
36	OPEN BURNER KNOB **USED WITH PN 1660 OR 1651**	36330	4	6	8	10	12
	OVEN THERMOSTAT KNOB (USED WITH PN 1159 OR 1179)	36328	1	1	1	2	2
	GRIDDLE THERMOSTAT KNOB (USED WITH PN 1159 OR 1179)	36571	1	2	2	3	3
	MANUAL/RAISED GRIDDLE KNOB (USED WITH PN 1651)	36015	2	3	4	5	6
	SPECIFY COLOR OF KNOB & BURNER VALVE PN WHEN ORDERING						
37	DOOR RIVETS (STAINLESS STEEL)	1070	8	8	8 OR 16	16	16
38	KICK PLATE (STAINLESS STEEL) PIVOT STYLE 20" OVEN	20142	1		2		
	KICK PLATE (STAINLESS STEEL) PIVOT STYLE 26-1/2" OVEN	20143		1	1	2	2

CIR Series - Medium Duty Ranges w/ Standard Oven

ITEM NO	DESCRIPTION	PART #	24"	36"	48"	60"	72"
	KICK PLATE BRACKET (ONLY USED ON PIVOT STYLE KICK PLATE)	20144	1	1	1	2	2
39	DOOR COMPLETE ASSEMBLY (20" OVEN)	20090	1		2		
	DOOR COMPLETE ASSEMBLY (26-1/2" OVEN)	2688		1	1	2	2
	ASSEMBLY CONSISTS OF NEXT 7 ITEMS						
40	DOOR COVER (STAINLESS STEEL) 20" OVEN	20150	1		2		
	DOOR COVER (STAINLESS STEEL) 26-1/2" OVEN	20151		1	1	2	2
41	OVEN DOOR HANDLE (STAINLESS STEEL) 20" OVEN	36099	1		2		
	OVEN DOOR HANDLE (STAINLESS STEEL) 26-1/2" OVEN	36100		1	1	2	2
42	DOOR HANDLE BRACKET (LEFT OR RIGHT)	36101/2	2	2	2	4	4
43	IMPERIAL LOGO	1205	1	1	1 OR 2	2	2
	NAME PLATE SPEED NUT	1027	2	2	2 OR 4	4	4
44	DOOR INSULATION (20" OVEN)	20154	1		2		
	DOOR INSULATION (26-1/2" OVEN)	20155		1	1	2	2
45	DOOR CLOSING MECHANISM (20" OVEN)	20160	1		2		
	DOOR CLOSING MECHANISM (26-1/2" OVEN)	20161		1	1	2	2
46	DOOR LINER (20" OVEN) PORCELAINIZED	20156	1		2		
	DOOR LINER (26-1/2" OVEN) PORCELAINIZED	20157		1	1	2	2
47	OVEN RACK (20" OVEN)	2120	1		2		
	OVEN RACK (26-1/2" OVEN)	2130		1	1	2	2
48	12" CRUMB TRAY	20002	1	1	1	1	1
	24" CRUMB TRAY	20003	1		2		
	36" CRUMB TRAY	20004		1			2
	48" CRUMB TRAY	20005			1		
49	THERMOSTAT BULB CLIP	1012	1	1	1 OR 2	2	2
50	RIGHT SIDE FRONT PANEL (STAINLESS STEEL)	20110		1			1
	LEFT SIDE FRONT PANEL (STAINLESS STEEL) FOUND ONLY ON 72 " UNIT	20111					1
51	26-1/2" OVEN ORIFICE, NATURAL GAS	2061		1	1	2	2
	26-1/2" OVEN ORIFICE, PROPANE GAS	2065		1	1	2	2
	20" OVEN ORIFICE, NATURAL GAS	2074	1		2		
	20" OVEN ORIFICE, PROPANE GAS	2076	1		2		
53	IGNITION WIRE (USED WITH PN 10001)	1285	2	3	4	5	6
54	MANUAL SPARK IGNITER (WITH RED BUTTON)	1075	1	1	1 OR 2	2	2
55	OVEN THERMOCOUPLE (USED WITH PN 1179 OR 1159)	1265	1	1	1 OR 2	2	2
	OPEN BURNER/GRIDDLE THERMOCOUPLE (USED WITH PN 1120 OR 1119)	1215	1	1	1 OR 2	2	2
56	OVEN PILOT BURNER (NATURAL GAS)	1120	1	1	1 OR 2	2	2
	OVEN PILOT BURNER (PROPANE GAS)	1119	1	1	1 OR 2	2	2
	3/16" FERREL (OVER SIZED)	1631	1	1	1 OR 2	2	2
	3/16" COMPRESSION FITTING (NUT)	1637	1	1	1 OR 2	2	2
57	OVEN PILOT ORIFICE (NATURAL GAS)	1291	1	1	1 OR 2	2	2
	OVEN PILOT ORIFICE (PROPANE GAS)	1292	1	1	1 OR 2	2	2
58	3/16" ALUMINIZED TUBING (**SPECIFY LENGTH OF TUBING)	2101-**	1	1	1 OR 2	1 OR 2	1 OR 2
	1/4" ALUMINIZED TUBING (**SPECIFY LENGTH OF TUBING)	2105-**	1	1	1 OR 2	1 OR 2	1 OR 2
59	OVEN BOTTOM (20" OVEN) PORCELAINIZED	20158	1		2		
	OVEN BOTTOM (26-1/2" OVEN) PORCELAINIZED	20159		1	1	2	2
60	CASTER (6" WITH SWIVEL PLATE)	1060	2	2	2	2	3
	CASTER WITH BRAKE (6" WITH SWIVEL PLATE)	1061	2	2	2	2	3
61	6" LEG WITH ADJUSTABLE FOOT	30555	4	4	4	4	6
62	14" X 3/4" SCREW (3 PER LEG & 4 PER CASTER)	1900	12 OR 16	12 OR 16	12 OR 16	12 OR 16	18 OR 24
63	OVEN FLAME SPREADER (20" OVEN)	20135	1		2		
	OVEN FLAME SPREADER (26-1/2" OVEN)	31584		1	1	2	2
64	OVEN BURNER WITH AIR SHUTTER	2099	1	1	1	2	2
67	24" REAR ANGLE SUPPORT	20180	1	1	1	1	1
	36" REAR ANGLE SUPPORT	20181		1	1	1	1
	48" REAR ANGLE SUPPORT	20182			1	1	1
	60" REAR ANGLE SUPPORT	20183				1	1
	72" REAR ANGLE SUPPORT	20184					1
	23" REAR ANGLE SUPPORT (ONLY ON UNITS WITH RAISED GRIDDLE)	20205	1	1	1	1	1
	35" REAR ANGLE SUPPORT (ONLY ON UNITS WITH RAISED GRIDDLE)	20206		1	1	1	1
47" REAR ANGLE SUPPORT (ONLY ON UNITS WITH RAISED GRIDDLE)	20207			1	1	1	
68	24" FRONT ANGLE SUPPORT	20185	1	1	1	1	1
	36" FRONT ANGLE SUPPORT	20186		1	1	1	1
	48" FRONT ANGLE SUPPORT	20187			1	1	1
	60" FRONT ANGLE SUPPORT	20188				1	1
	72" FRONT ANGLE SUPPORT	20189					1
	23" FRONT ANGLE SUPPORT (ONLY ON UNITS WITH RAISED GRIDDLE)	20215	1	1	1	1	1
	35" FRONT ANGLE SUPPORT (ONLY ON UNITS WITH RAISED GRIDDLE)	20216		1	1	1	1
	47" FRONT ANGLE SUPPORT (ONLY ON UNITS WITH RAISED GRIDDLE)	20217			1	1	1
69	12" LANDING LEDGE (RAISED GRIDDLE ONLY) STAINLESS STEEL	20258	1	1	1	1	1
	24" LANDING LEDGE STAINLESS STEEL	20250	1	1	1	1	1
	36" LANDING LEDGE STAINLESS STEEL	20251		1	1	1	1
	48" LANDING LEDGE STAINLESS STEEL	20252			1	1	1
	60" LANDING LEDGE STAINLESS STEEL	20253				1	1
	72" LANDING LEDGE STAINLESS STEEL	20254					1
	25" LANDING LEDGE (ONLY ON UNITS WITH RAISED GRIDDLE)	20255	1	1	1	1	1

CIR Series - Medium Duty Ranges w/ Standard Oven

ITEM NO	DESCRIPTION	PART #	24"	36"	48"	60"	72"
	37" LANDING LEDGE (ONLY ON UNITS WITH RAISED GRIDDLE)	20256		1	1	1	1
	49" LANDING LEDGE (ONLY ON UNITS WITH RAISED GRIDDLE)	20257			1	1	1
70	MANIFOLD BRACKET	20022	1	1	1	1	1
71	CRUMB TRAY BACK STOP	20220	1	1	2	2	2
72	FLUE BOX	20225	1	1	1	2	2
73	SIDE PANEL (STAINLESS STEEL)	20240S	2	2	2	2	2
	SIDE PANEL FOR RAISED GRIDDLE (STAINLESS STEEL) LEFT OR RIGHT	20241S	1	1	1	1	1
	IR SIDE PANEL LEFT HAND	31617	1	1	1	1	1
	IR SIDE PANEL RIGHT HAND	31618	1	1	1	1	1
74	24" BACKGUARD ASSEMBLY	20200S	1				
	36" BACKGUARD ASSEMBLY	20201S		1			
	48" BACKGUARD ASSEMBLY	20202S			1		
	60" BACKGUARD ASSEMBLY	20203S				1	
	72" BACKGUARD ASSEMBLY	20204S					1
	ADD -12 OR -24 (SIZE OF RAISED GRIDDLE) FOR R/G BACKGUARD	***_**					
	ASSEMBLY CONSISTS OF NEXT 4 ITEMS						
	24" SHELF (STAINLESS STEEL)	20190	1				
	36" SHELF (STAINLESS STEEL)	20191		1			
	48" SHELF (STAINLESS STEEL)	20192			1		
	60" SHELF (STAINLESS STEEL)	20193				1	
	72" SHELF (STAINLESS STEEL)	20194					1
	24" BACKGUARD	20100S	1				
	36" BACKGUARD	20101S		1			
	48" BACKGUARD	20102S			1		
	60" BACKGUARD	20103S				1	
	72" BACKGUARD	20104S					1
	ADD -12 OR -24 (SIZE OF RAISED GRIDDLE) FOR R/G BACKGUARD	***_**					
	24" OUTSIDE BACK FOR BACKGUARD (GALVANIZED)	20195	1				
	36" OUTSIDE BACK FOR BACKGUARD (GALVANIZED)	20196		1			
	48" OUTSIDE BACK FOR BACKGUARD (GALVANIZED)	20197			1		
	60" OUTSIDE BACK FOR BACKGUARD (GALVANIZED)	20198				1	
72" OUTSIDE BACK FOR BACKGUARD (GALVANIZED)	20199					1	
CHANNEL SUPPORT FOR STANDARD BACKGUARD	20030						
* REINFORCEMENT CHANNEL TO RANGE MOUNT CHEESE MELTERS OR SALAMANDERS SEE PAGE 11 OR 13							
75	24" STUB BACK ASSEMBLY	20075	1				
	36" STUB BACK ASSEMBLY	20076		1			
	48" STUB BACK ASSEMBLY	20077			1		
	60" STUB BACK ASSEMBLY	20078				1	
	72" STUB BACK ASSEMBLY	20079					1
	ADD -12 OR -24 (SIZE OF RAISED GRIDDLE) FOR R/G BACKGUARD	***_**					
	ASSEMBLY CONSISTS OF NEXT 2 ITEMS						
	24" FRONT PANEL (STAINLESS STEEL)	20095	1				
	36" FRONT PANEL (STAINLESS STEEL)	20096		1			
	48" FRONT PANEL (STAINLESS STEEL)	20097			1		
	60" FRONT PANEL (STAINLESS STEEL)	20098				1	
	72" FRONT PANEL (STAINLESS STEEL)	20099					1
	ADD -12 OR -24 (SIZE OF RAISED GRIDDLE) FOR R/G BACKGUARD	***_**					
	24" OUTSIDE BACK (GALVANIZED)	20081	1				
	36" OUTSIDE BACK (GALVANIZED)	20082		1			
	48" OUTSIDE BACK (GALVANIZED)	20083			1		
60" OUTSIDE BACK (GALVANIZED)	20084				1		
72" OUTSIDE BACK (GALVANIZED)	20085					1	
IR RAISED GRIDDLE / BROILER							
76	12" RAISED GRIDDLE ASSEMBLY	20012	1	1	1	1	1
	24" RAISED GRIDDLE ASSEMBLY	20013	1	1	1	1	1
77	BURNER ASSEMBLY WITH AIR SHUTTER & WIRE MESH	20125	1	1	1	1	1
	WIRE MESH FOR RAISED GRIDDLE BURNER	20126	1	1	1	1	1
78	MANIFOLD PIPE (CALL FACTORY FOR MORE INFO)		1	1	1	1	1
79	GREASE CAN - FOR RAISED GRIDDLE BURNER	20042	1	1	1	1	1
80	VALVE COVER - STAINLESS STEEL (CALL FACTORY FOR MORE INFO)		1	1	1	1	1
81	12" CRUMB TRAY - FOR RAISED GRIDDLE/BROILER	20017	1	1	1	1	1
	24" CRUMB TRAY - FOR RAISED GRIDDLE/BROILER	20018	1	1	1	1	1
82	12" DRIP PAN - FOR RAISED GRIDDLE/BROILER	20014	1	1	1	1	1
	24" DRIP PAN - FOR RAISED GRIDDLE/BROILER	20015	1	1	1	1	1
83	12" RACK - FOR RAISED GRIDDLE/BROILER	2024	1	1	1	1	1
	24" RACK - FOR RAISED GRIDDLE/BROILER	2025	1	1	1	1	1
84	1/8" PRESSURE TAP	1255					
85	1/4" TO 3/16" ORIFICE ELBOW REDUCER (USED WITH PN 1651)	1640	2	3	4	5	6
86	(LPG) PIN FOR CIR THERMOSTAT (1179)	1320	1	1	1	2	2
	(NAT) PIN FOR CIR THERMOSTAT (1179)	1321	1	1	1	2	2



FOOD SERVICE SPARES LTD

UNIT 4 SANDBROOK PARK, SANDBROOK WAY, ROCHDALE, OL11 1RY

01706 353 633

SALES@FOODSERVICESPARES.COM



WWW.FOODSERVICESPARES.COM